

Appendix Q



Long Beach Police Department
Service Information



CITY OF LONG BEACH

POLICE DEPARTMENT

400 WEST BROADWAY LONG BEACH CALIFORNIA 90802

Robert G. Luna
Chief of Police

Ref 4.1E

January 12, 2017

Stephanie Eyestone-Jones
President
6701 Center Drive West, Suite 900
Los Angeles, California 90045

Dear Ms. Eyestone-Jones

This letter is in response to your request for information from the Long Beach Police Department in order for you to complete an Environmental Impact Report (EIR) for the 2nd & PCH Project as required by the City Development Services Department.

Your project located at 6400 East Pacific Coast Highway in the City of Long Beach is located within the boundaries of the East Patrol Division in Reporting District (RD) 623. The East Patrol Division is located at 3800 East Willow Street, Long Beach, California 90815. The East Patrol Division's boundaries are East of Cherry Avenue to the city limits, to the north city limits at Del Amo and Carson, and south to the ocean. Attached is a map of the East Division which includes reporting districts and a 2010 Census Tract Boundaries map for your reference.

The East Division consists of 101 sworn officers and three civilian employees. The total number of budgeted sworn officers department wide is 814. Our specialized units that could be called to the project location if needed is a SWAT Team, K9 Team, Mental Evaluation Team, Detectives and an Air Support Unit.

The Long Beach Police Department categorizes response by priority. This is done by our Communications Center under the Department of Disaster Preparedness. Calls for service are categorized as defined below:

Priority 1 – The life or property of a citizen is in imminent danger

Priority 2 – Disturbance of the peace or general well-being

Priority 3 – Reports and parking problems

ADMINISTRATION BUREAU
(562) 570-5830
FAX (562) 570-5833

FINANCIAL BUREAU
(562) 570-7447
FAX (562) 570-5833

INVESTIGATIONS BUREAU
(562) 570-7350
FAX (562) 570-5837

PATROL BUREAU
(562) 570-7214
FAX (562) 570-7058

SUPPORT BUREAU
(562) 570-7342
FAX (562) 570-6018

Response times for East Division average 5.3 minutes for Priority 1, 24.3 minutes for Priority 2, and 39 minutes for Priority 3 calls for service compared to citywide average response times of

4.8, 24.6 and 35.4 respectively. The Department's goal is a response time of under five minutes for Priority 1 calls for service.

As previously stated, your project is located in RD 623. For statistics on crime in that RD, please refer to our website at <http://www.longbeach.gov/police/crime-info/crime-statistics/>. This will provide you monthly statistics for the RD for the last two years as well as a five year summary.

If you have any further questions, please contact East Division Commander Liz Griffin at (562)570-5558 or elizabeth.griffin@longbeach.gov.

Sincerely,

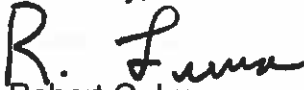

Robert G. Luna
Chief of Police

RGL/ECG/ecg
Environmental Impact Report - 6400 E. PCH - 01-11-17

Enclosures: Police Reporting Districts Map
2010 Census Tract Boundaries

City of Long Beach
California

Police Reporting Districts with Divisions & Beats

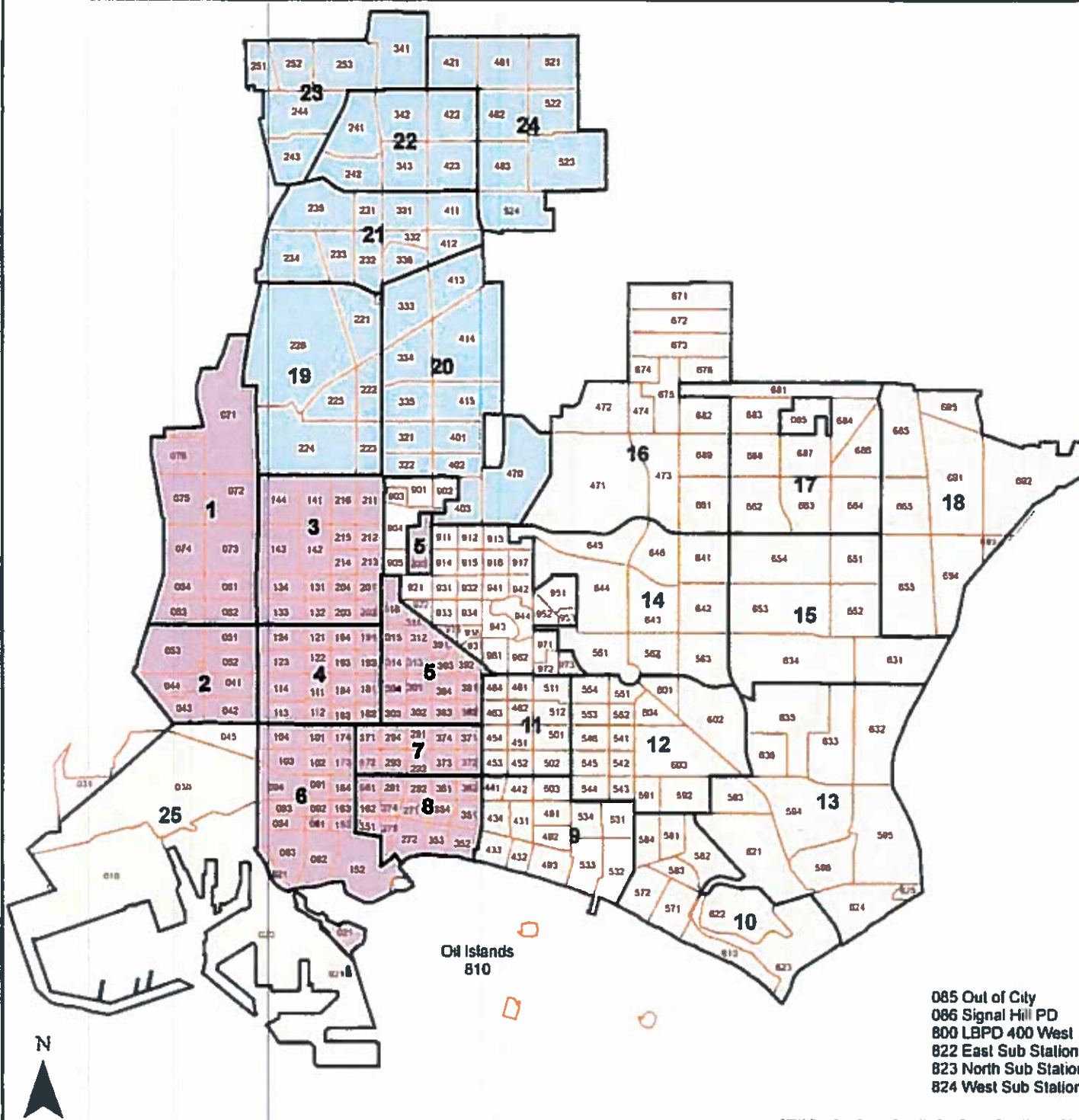

Legend

- Police Reporting Districts
- Police Beats
- Police Divisions**
- North
- East
- West
- Port
- Signal Hill & LA County (not covered)



Department of
Technology & Innovation GIS

As of October 2014

085 Out of City
086 Signal Hill PD
800 LBPD 400 West
822 East Sub Station
823 North Sub Station
824 West Sub Station

Disclaimer
This map is the City of Long Beach's property for information purposes only. While reasonable effort has been made to ensure the accuracy of the data, the City assumes no liability or damages arising from errors or omissions. This map is provided without warranty of any kind.

City of Long Beach,
California

2010 Census Tract Boundaries

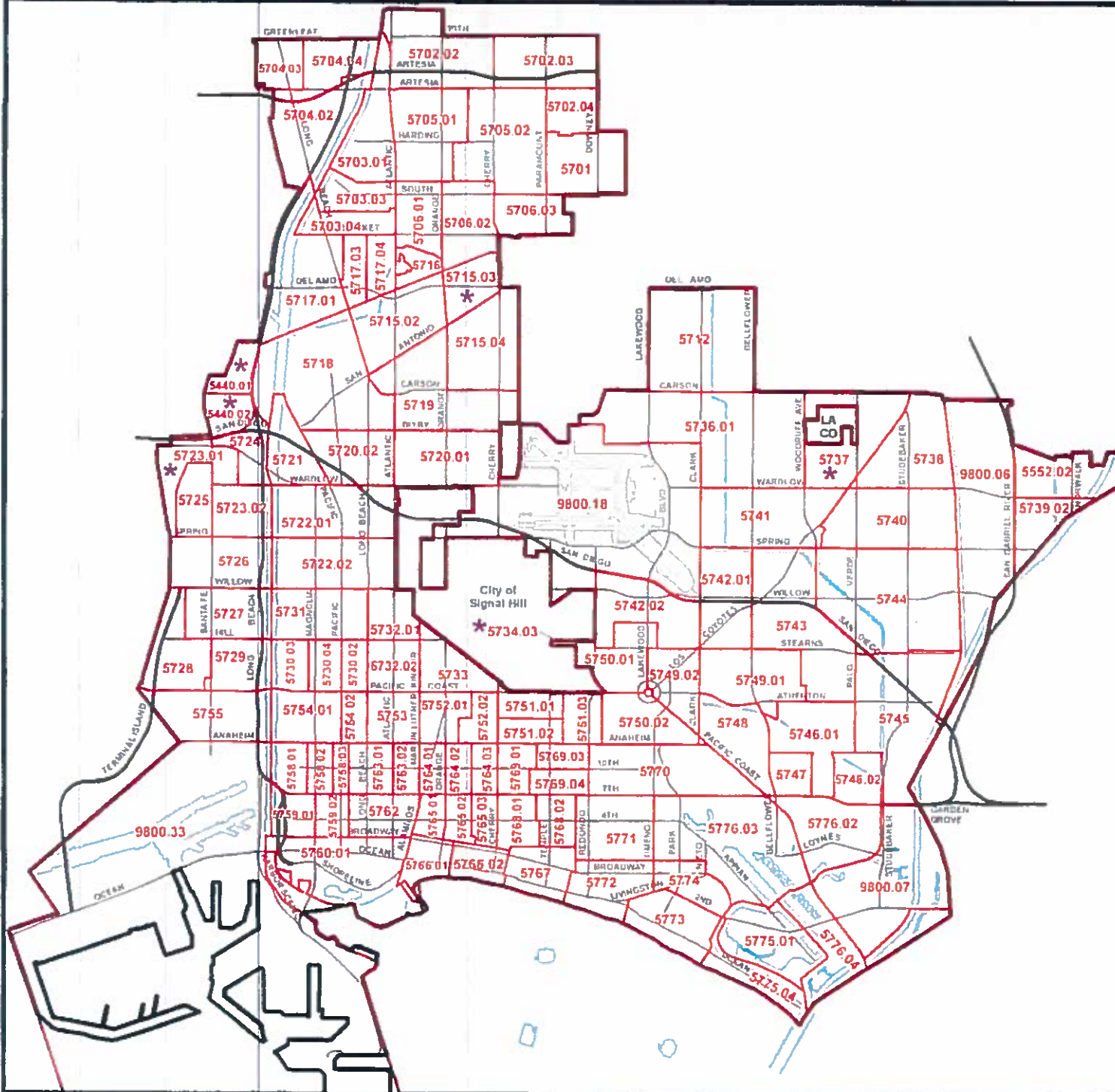

Map Features

 2010 Census Tracts

5775.01 Tract Number

 Only portion of tract shown - extends to neighboring jurisdictions



Department of
Technology Services GIS

